

Instructions for Photo Wall Clock

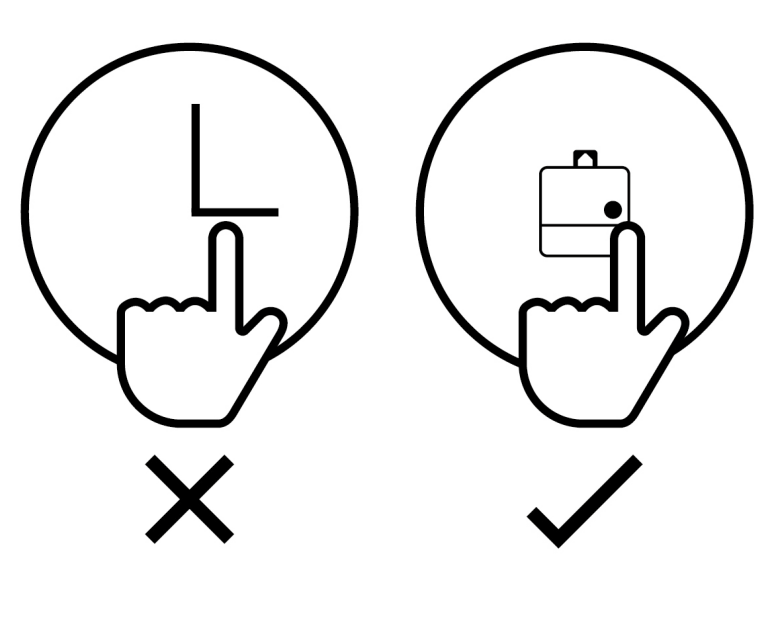

1 Unpack the watch and set it. Only set the hands with the adjusting wheel on the back of the watch. Moving the hands by hand can damage the movement.

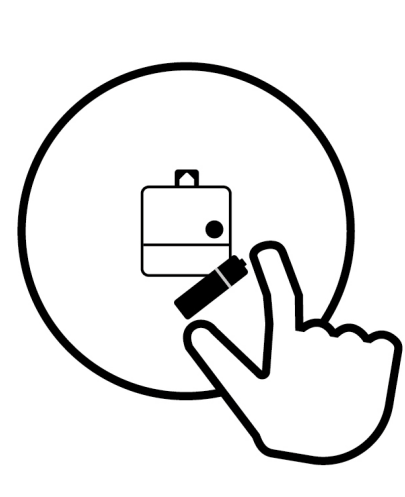

2 Insert the supplied battery and the clock is ready for use.

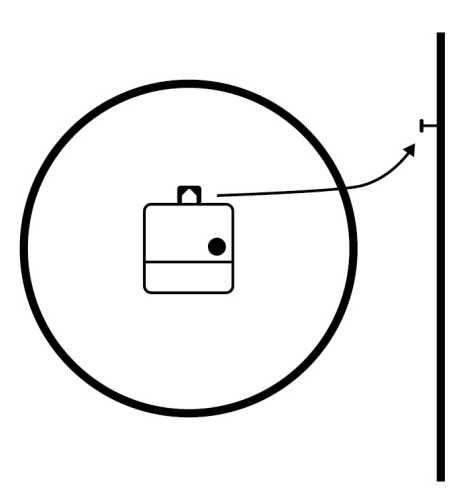

3 You can hang the clock with a nail or a screw, depending on the wall condition. These are available separately and are not included in the delivery. Use the existing suspension device for the suspension.



x 1

Accessories supplied for Photo Wall Clock

General instructions

- Use the existing hanging device.
- A dry cloth is suitable for cleaning. Clean with a feather duster.
- Do not use water.
- Do not expose to direct sunlight.
- Do not hang directly over a radiator.
- Not suitable for outdoor use.
- Proper disposal for the sake of the environment.

To protect our environment!

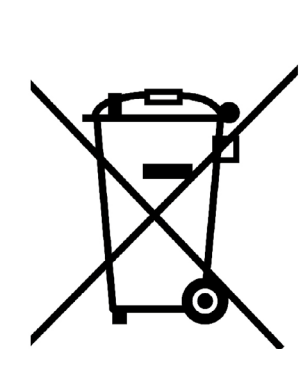

In connection with the delivery of devices containing batteries, we are obliged to inform you of the following:

Batteries and rechargeable batteries must not be disposed of in household waste, but you are legally obliged to return used batteries as the end user. Used batteries may contain harmful substances that can damage the environment or your health if not stored or disposed of properly. You can return used batteries that we stock or have stocked as new batteries free of charge to retailers or municipal collection points or send them back to our shipping address. The return is limited to the usual quantities for end users and to those spent batteries that we carry or have carried as new batteries in our range.

The sign with the crossed-out dustbin means that you may not dispose of the batteries and rechargeable batteries in the household waste. Below this symbol you will also find the following symbols with the following meaning:

- Pb: Battery contains more than 0.004% lead by mass.
- Cd: Battery contains more than 0.002% cadmium by mass.
- Hg: Battery contains more than 0.0005% mercury by mass.

In addition, the following applies in Switzerland:

INOBAT is responsible for disposal and recycling, but also for informing consumers. It was founded in 1991 and commissioned by the Federal Office for the Environment (FOEN). INOBAT also collects and uses the so-called advance disposal fee (VEG), which you pay for each battery when you buy it.

Prepaid recycling fee (ARF) for Switzerland

The prices of Ifolor AG (Switzerland) include the prepaid recycling fee (ARF). The ARF stipulates that consumers must return devices with electronic/electrical components for proper disposal. A nationwide take-back system exists for this purpose. The returned appliances are sent to certified disposal companies, where up to 75% of the materials can be recovered. More information: www.erecycling.ch.